

SLG 419AR

Circular connectors "SHOW-BIZ"



CHARACTERISTICS

- 2x6 contacts are used to provide power and 7 socket first mate last break earth contacts have a grounding function.
- In this way, each equipment has its own ground.
- The 7 grounding contacts are identified from the others by their plating, in order to improve the cabling process and also to allow a quick visual differentiation between standard SL419AR and SLG419AR connectors.
- As for SL Series, all sockets are protected by a closed entry to warranty an outstanding safety in use.
- Available in female receptacle and in line female receptacle.



Female receptacle SLG EF 419 AR



Female in line receptacle SLG FFDR 419 AR

DESCRIPTION

SLG419AR connector, derived from the SL series, has been developed to meet the new requirements of the industrial market as far as safety of the user and of the equipment are concerned. SLG419AR connectors provides 19 solder termination contacts (size 12) which accept each 25 A.

SLG419AR is different from the standard version by its 7 sockets which are located in the centre of the insert to ensure the «first mate last break» fonction.

*7 first mate
last break
earth contacts*

APPLICATIONS

- Power supplies of 6 brand-lights for entertainment applications.
- Power supplies with independent grounding.

SLG 419AR



Amphenol

Mechanical characteristics

- Aluminium alloy molded shells
- Mating by screwing system
- Alkydes inserts
- Gold plated copper alloy machined contacts (gold plated on nickel underplate for power contacts, electrolytic nickel plated for grounded contacts)
- Closed entry female contacts
- Reinforced mating screw
- Temperature range : -40°C to 85°C

Electrical characteristics

- Contact gauge AWG : 12
- Nominal current: 25 A
- Contact resistance < 0.002 Ohm
- Solder pot internal diameter: 2.5 mm

Contact arrangement electrical characteristics

- Test voltage at sea level: 1750 Vrms
- Working voltage in accordance with NF C 20-040, environmental conditions II : 400 Vrms
- Conform to new USITT's specifications (American governmental agency)

Accessories

Please consult the standard SL data-sheet.

Dimensional characteristics

Panel drilling for square flange receptacle

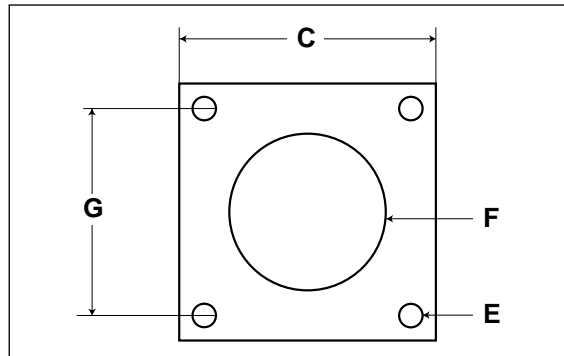

Receptacle size	C mm	Diam. E mm	Diam. F mm	G mm
40	56	3.5	47	41

Please see the standard SL data-sheet for other dimensions (E101).

Insert arrangement

Mating face view of the female insert

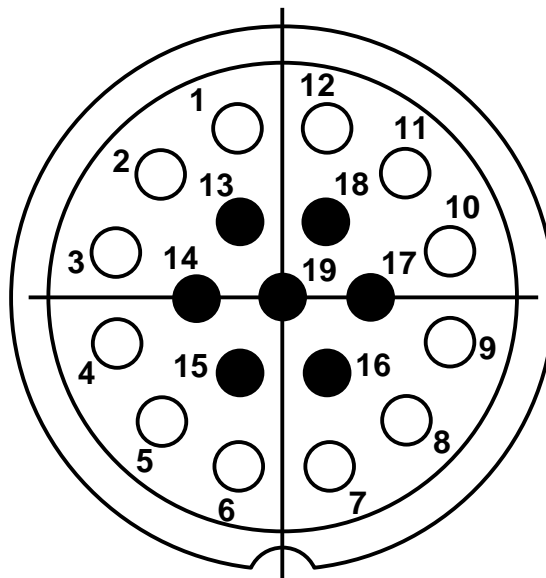

- First mate last break contact

In-line receptacle or plug body

SL series	SL	G	-	B	F	-	419AR
G:	7 first mate last break earth contacts (for 419AR only)						
Shell finish:	None: standard white cadmium plated AS: black conductive D: black non-conductive						
Shell:	B: mobile plug or in-line receptacle						
Contacts:	F: socket						
Shell style:	None: mobile plug R: in-line receptacle						
Contact arrangement:	419AR						

(Please consult us for mobile plug or in-line receptacle which allows one-part black conductive backshell to screw on mobile plug or receptacle and cable seal PG type).

Square flange receptacle or square flange receptacle with mating screw

SL series	SL	G	-	F	M	-	419AR
G:	7 first mate last break earth contacts (for 419AR only)						
Shell finish:	None: standard white cadmium plated AS: black conductive D: black non-conductive						
Shell:	E: receptacle						
Contacts:	F: socket						
Shell style:	None: square flange receptacle E: square flange receptacle with mating screw						
Contact arrangement:	419AR						

Right angle or straight backshells

Connector size	Backshell with cable-clamp P/N			
	straight		right angle	
	black (non conductive)	green cadmium (conductive)	black (non conductive)	green cadmium (conductive)
40	47380N	21461N	47384N	21465N

- Green backshell (conductive finish) are equipped with conductive clamping pads.

Do not hesitate to contact us for further information



Monopiece SL61



Amphenol

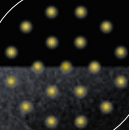

Socapex

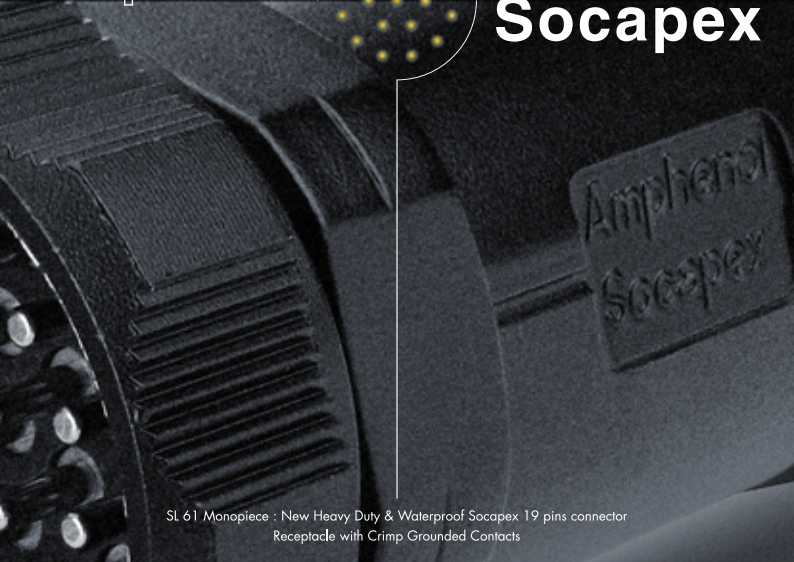

SL 61 Monopiece : New Heavy Duty & Waterproof Socapex 19 pins connector
Receptacle with Crimp Grounded Contacts

SL61 Monopiece & New Receptacle

New SL61 Monopiece Backshell

Metallic backshell.

Waterproof IP67 rated.

100% compatible with all the Socapex 419AR range.

Socapex exclusive gland design to ensure a high mechanical retention of the cable.

Gland available in Size 29 or 36 according to the outside diameter of the cable.

Socapex exclusive thread design to avoid accidental unscrewing of the backshell while mating / unmating.

Built-in double insulation and black non conductive plating for safety.

Solder and crimp contacts available.

Contacts size 12 (AWG14-12, conductor diameter up to 2,45 mm / 0.1 in).

The Socapex split backshell (47380N) can be used with the new plug.

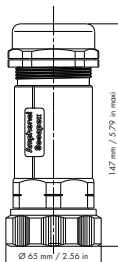
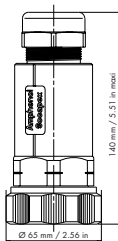

Size 29

Plugs	Cable diameter 15 mm / 0.59 in to 24 mm / 0.94 in		
	Plug alone	Backshell	Complete Set Plug + Backshell
Black, Solder	SLD BMFG 419AR	47029N	SLD FMD PG29 419AR
Black, Crimp	SLXD BMFG 419AR	47029N	SLXD FMD PG29 419AR

In line Receptacles	Cable diameter 15 mm / 0.59 in to 24 mm / 0.94 in		
	Plug alone	Backshell	Complete Set Plug + Backshell
Black, Solder	SLD BFRPG 419AR	47029N	SLD FFDR PG29 419AR
Black, Solder 7 ground Contacts	SLGD BFRPG 419AR	47029N	SLGD FFDR PG29 419AR
Black, Crimp	SLXD BFRPG 419AR	47029N	SLXD FFDR PG29 419AR
Black, Crimp 7 ground Contacts	SLXGD BFRPG 419AR	47029N	SLXGD FFDR PG29 419AR

Size 36

Plugs	Cable diameter 24 mm / 0.94 in to 34 mm / 1.34 in		
	Plug alone	Backshell	Complete Set Plug + Backshell
Black, Solder	SLD BMFG 419AR	47036N	SLD FMD PG36 419AR
Black, Crimp	SLXD BMFG 419AR	47036N	SLXD FMD PG36 419AR

In line Receptacles	Cable diameter 24 mm / 0.94 in to 34 mm / 1.34 in		
	Plug alone	Backshell	Complete Set Plug + Backshell
Black, Solder	SLD BFRPG 419AR	47036N	SLD FFDR PG36 419AR
Black, Solder 7 ground Contacts	SLGD BFRPG 419AR	47036N	SLGD FFDR PG36 419AR
Black, Crimp	SLXD BFRPG 419AR	47036N	SLXD FFDR PG36 419AR
Black, Crimp 7 ground Contacts	SLXGD BFRPG 419AR	47036N	SLXGD FFDR PG36 419AR

New Panel Receptacle

with crimp contacts (7 First Mate Last Break Contacts for grounding)

SLX GD EF 419AR

Black non conductive plating.

12 female crimp contacts included [Size 12].

7 longer contacts for First Mate Last Brake mating.



Tooling for crimp contacts	
Crimping plier	809 857 (M22520/1-01)
Positionner	21 770
Controlling gauge	809 907 (M22520/3-1)
Insertion tool	141 900 (Screwdriver type)
	809 735 (Plier type)
Removal tool	21 746 (Pin contacts)
	21745 (Sik contacts)



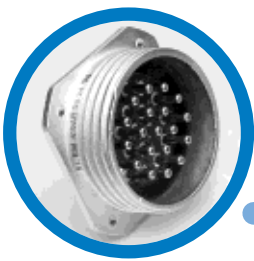

SL 61

Industrial Circular Connectors



NEW
Cadmium-free versions
(nickel plating)

MAIN CHARACTERISTICS

- Closed entry female contacts
- Inserts moulded in Alkyde
- Trapezoidal thread screw-locking
- Two parts backshell ensuring simple wiring and maintenance
- Adaptable capacity cable clamp
- Gold plated turned contacts
- Reinforced locking ring
- Solder contacts
- Please contact us for other contact terminations
 - for crimping
 - for soldering with earth protection
- Size 40 one piece backshell (please consult us)
- Working temperature:
 - 40°C / + 85°C
- Current capability:
 - 7.5, 10, 25 and 50 Amps
- Operating voltage:
 - to 600 Volts
- Cadmium-free versions (Ni)
- UL recognition n° E160967(01) for 419AR layout

- Large selection of insert arrangements
- Robust and reliable
- Stock items



DESCRIPTION

Principally aimed at I/O applications, the SL61 connectors are available in 4 types of housing (10, 20, 30 and 40) and 26 arrangements from 2 to 61 mixed solder contacts. They are available in the following configurations:

- Plugs
- Receptacles
- Line mount receptacles
- Receptacles with locking ring

Connectors are made of aluminium alloy which provides them excellent reliability and robustness.

When application requires greater performances, the sealing can be improved by the use of a sprayproofing sleeve.

*Robustness
and reliability*

APPLICATIONS

- Automation
- Instrumentation
- Robotics
- Power distribution
- Transport
- Entertainment (brand-lights)

SL 61



Amphenol

Contact arrangements

①	13 U	14 V	17 P	22 B	23 C	23 AL	25 D	25 S	27 E	29 AE	212 AF
② (Vrms)	280	225	150	500	440	540	380	380	380	280	280
③ (Vrms)	1400	1400	1050	2100	1400	1750	1400	1400	1400	1400	1050
①	222 P	32 F	33 G	34 H	315 K	319 L	37 Y	39 J	337 P		
② (Vrms)	150	525	600	500	355	400	480	450	175		
③ (Vrms)	1050	1750	1750	1750	1750	1750	1750	1750	1050		
①	443 AP	461 P	48 M	419 AR	426 P	439 R					
② (Vrms)	300	110	420	400	380	280					
③ (Vrms)	1750	1050	2500	1750	1750	1750					

- ① Contact arrangement
- ② Working voltage
- ③ Test voltage at sea level

Nominal current	Contact resistance	Maximum permissible wire dia.
• 7,5 A	≤ 5 m Ω	0.75 mm ²
○ 10 A	≤ 2 m Ω	1.75 mm ²
● 25 A	≤ 2 m Ω	5.1 mm ²
⊕ 50 A	≤ 2 m Ω	13 mm ²





REMARK: the second and the third digit of the contact arrangements (if the third exists) indicate the number of contacts in the arrangement.
Ex. : 426P = 26 contacts.

Straight or right-angle backshell

Connector size	Backshell reference					
	black (non conductive)	straight nickel (conductive)	green cadmium (conductive)	black (non conductive)	right-angle nickel (conductive)	green cadmium (conductive)
10	47377N	47377NI	21458N	47381N	47381NI	21462N
20	47378N	47378NI	21459N	47382N	47382NI	21463N
30	47379N	47379NI	21460N	47383N	47383NI	21464N
40	47380N	47380NI	21461N	47384N	47384NI	21465N

- Straight or right-angle backshells are delivered with different clamping pads.
- Green backshells (conductive finish) are delivered with metallised clamping pads.

Accessories

<p>Plug and receptacle protection caps:</p> <table border="1"> <thead> <tr> <th>SLB</th> <th>F</th> <th>M</th> <th>3B</th> </tr> </thead> <tbody> <tr> <td>F: Plug</td> <td></td> <td></td> <td></td> </tr> <tr> <td>E: Receptacle</td> <td></td> <td></td> <td></td> </tr> <tr> <td>M: Pin connector</td> <td></td> <td></td> <td></td> </tr> <tr> <td>F: Socket connector</td> <td></td> <td></td> <td></td> </tr> <tr> <td>Plug and receptacle: none</td> <td></td> <td></td> <td></td> </tr> <tr> <td>Line mount receptacle: R</td> <td></td> <td></td> <td></td> </tr> <tr> <td>Size</td> <td></td> <td></td> <td></td> </tr> <tr> <td>1B: 10</td> <td>3B: 30</td> <td></td> <td></td> </tr> <tr> <td>2B: 20</td> <td>4B: 40</td> <td></td> <td></td> </tr> </tbody> </table> 	SLB	F	M	3B	F: Plug				E: Receptacle				M: Pin connector				F: Socket connector				Plug and receptacle: none				Line mount receptacle: R				Size				1B: 10	3B: 30			2B: 20	4B: 40			<p>Receptacle with locking ring protection caps:</p> <table border="1"> <thead> <tr> <th>BF</th> <th>F</th> <th>3B</th> </tr> </thead> <tbody> <tr> <td>M: Pin connector</td> <td></td> <td></td> </tr> <tr> <td>F: Socket connector</td> <td></td> <td></td> </tr> <tr> <td>Size</td> <td></td> <td></td> </tr> <tr> <td>1B: 10</td> <td>3B: 30</td> <td></td> </tr> <tr> <td>2B: 20</td> <td>4B: 40</td> <td></td> </tr> </tbody> </table> 	BF	F	3B	M: Pin connector			F: Socket connector			Size			1B: 10	3B: 30		2B: 20	4B: 40		<p>Sealing sleeve:</p> <table border="1"> <thead> <tr> <th>Connector</th> <th>Size</th> <th>Ref.</th> </tr> </thead> <tbody> <tr> <td>Straight</td> <td>10</td> <td>43458</td> </tr> <tr> <td>Right-angle</td> <td>10</td> <td>43473</td> </tr> <tr> <td>Straight</td> <td>20</td> <td>43456</td> </tr> <tr> <td>or</td> <td>30</td> <td>44666</td> </tr> <tr> <td>Right-angle</td> <td>40</td> <td>43457</td> </tr> </tbody> </table>  <p>for plug or line mount receptacle</p>	Connector	Size	Ref.	Straight	10	43458	Right-angle	10	43473	Straight	20	43456	or	30	44666	Right-angle	40	43457	<p>Adaptator for flexible conduit and PG:</p> <table border="1"> <thead> <tr> <th></th> <th>Connector size</th> <th>PG thread</th> </tr> </thead> <tbody> <tr> <td>SL RF 209N</td> <td>20</td> <td>9</td> </tr> <tr> <td>SL RF 211N</td> <td>20</td> <td>11</td> </tr> <tr> <td>SL RF 313N</td> <td>30</td> <td>13</td> </tr> <tr> <td>SL RF 316N</td> <td>30</td> <td>16</td> </tr> <tr> <td>SL RF 416N</td> <td>40</td> <td>16</td> </tr> <tr> <td>SL RF 421N</td> <td>40</td> <td>21</td> </tr> <tr> <td>SL RF 429N</td> <td>40</td> <td>29</td> </tr> </tbody> </table> 		Connector size	PG thread	SL RF 209N	20	9	SL RF 211N	20	11	SL RF 313N	30	13	SL RF 316N	30	16	SL RF 416N	40	16	SL RF 421N	40	21	SL RF 429N	40	29
SLB	F	M	3B																																																																																																				
F: Plug																																																																																																							
E: Receptacle																																																																																																							
M: Pin connector																																																																																																							
F: Socket connector																																																																																																							
Plug and receptacle: none																																																																																																							
Line mount receptacle: R																																																																																																							
Size																																																																																																							
1B: 10	3B: 30																																																																																																						
2B: 20	4B: 40																																																																																																						
BF	F	3B																																																																																																					
M: Pin connector																																																																																																							
F: Socket connector																																																																																																							
Size																																																																																																							
1B: 10	3B: 30																																																																																																						
2B: 20	4B: 40																																																																																																						
Connector	Size	Ref.																																																																																																					
Straight	10	43458																																																																																																					
Right-angle	10	43473																																																																																																					
Straight	20	43456																																																																																																					
or	30	44666																																																																																																					
Right-angle	40	43457																																																																																																					
	Connector size	PG thread																																																																																																					
SL RF 209N	20	9																																																																																																					
SL RF 211N	20	11																																																																																																					
SL RF 313N	30	13																																																																																																					
SL RF 316N	30	16																																																																																																					
SL RF 416N	40	16																																																																																																					
SL RF 421N	40	21																																																																																																					
SL RF 429N	40	29																																																																																																					

Straight plug

Straight female plug

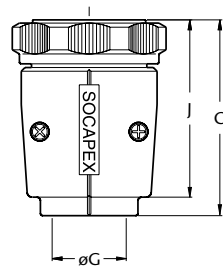

Straight male plug

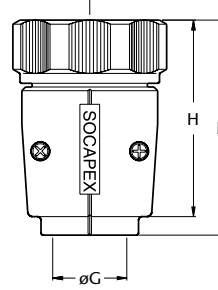

Right angle plug

Right-angle male plug

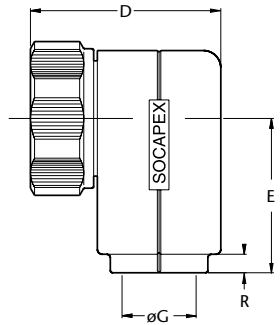

Right-angle female plug

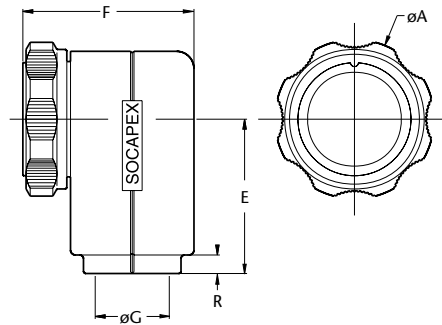

size	$\phi A - 0,2$ (mm)	B (mm)	C (mm)	D (mm)	E (mm)	F (mm)	G (mm)			H (mm)	J (mm)	K (mm)	L (mm)	M (mm)	N (mm)	R (mm)	S (mm)	T (mm)	W (mm)	Y (mm)
10	27.5	61.9	52.9	47.9	45.5	38.9	5-7	7-9	57.4	48.4	21	53.5	57.9	24	4.5	16.5	3.2	19	25	
20	36.5	66.5	59.8	55.5	51.5	48.8	6-8	9-11	12-14	62	55.3	28.1	61	59.8	32	4.5	25.5	3.5	24	31
30	51.5	88.5	80.8	68.5	55.5	60.8	10-12	13-16	17-20	82	74.3	42.2	82	80.8	45	6.5	35.5	3.5	34	46
40	64.5	86.5	78.8	76.5	62.5	68.8	14-18	19-23	24-30	79	71.3	52.2	80	79.6	54	7.5	47	3.5	41	56

G: flanges equipped with different clamping pads delivered with the backshells.

In-line receptacle

In-line male receptacle

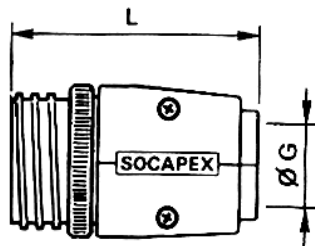

In-line female receptacle

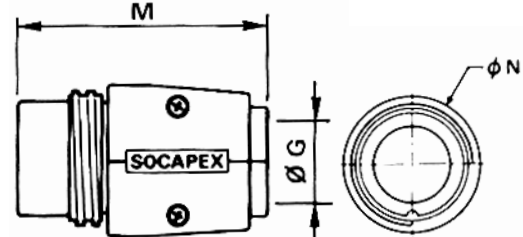

Receptacle

Male receptacle

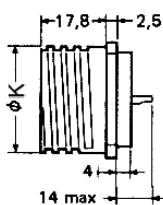

Female receptacle

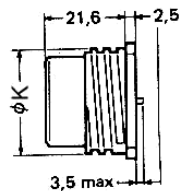

Male receptacle with locking ring

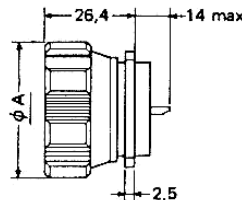

Female receptacle with locking ring

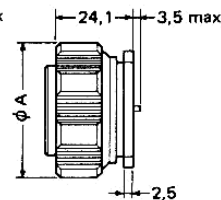

Square flange of receptacle

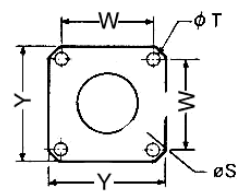

Plug and line mount receptacle (Bright cadmium or nickel plated)

SL series	SL	B	F	R	426 P	-
Plug or line mount receptacle						
Type of contact: Male M Female F						
Plug: none Line mount receptacle: R						
Contact arrangement (see page 2)						
Add "NI" for cadmium-free versions (nickel)						

Plug and backshell set

SL series	SL	F	M	D	426 P	-
F: plug or line mount receptacle						
Type of contact: Male M Female F						
D: plug + straight backshell DR: line mount receptacle + backshell C: plug + right angle backshell						
Contact arrangement (see page 2)						
Add "NI" for cadmium-free versions (nickel)						

Receptacle and receptacle with locking ring
(Bright cadmium or nickel plated)

SL series	SL	E	M	-	426 P	-	-
Receptacle or receptacle with locking ring: E							
Type of contact: Male M Female F							
Receptacle: none Receptacle with locking ring: E							
Contact arrangement (see page 2)							
Add "MA" for tin plated retention ring (grounding)							
Add "NI" for cadmium-free versions (nickel)							

Comment: Pannel gasket deliver with the receptacle

Do not hesitate to contact us for further information



SLX

Crimp version industrial circular connectors

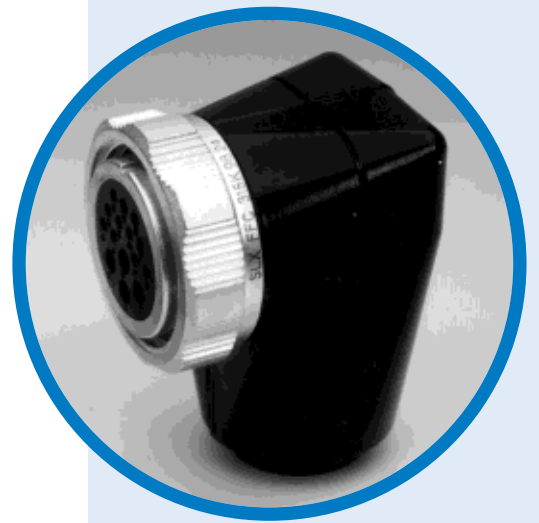

NEW
Cadmium-free versions
(nickel plating)

TECHNICAL CHARACTERISTICS

Mechanical characteristics

- 12 insert arrangements which accept contact gauges AWG 20, 16, 12, in the four different shell sizes 10, 20, 30 & 40
- Crimp removable gold plated on nickel underplate machined contacts
- Temperature range -55°C to 125°C
- Bright cadmium plated aluminium molded shells
- Mating by screwing system
- Strain-relief integrated to the backshell
- Neoprene inserts
- Reinforced mating screw
- Cadmium-free versions
- UL recognition n° E160967(01) for 419AR layout

Electrical characteristics

- Contacts characteristics

Contact gauge AWG	20	16	12
Contact diameter (mm)	1	1.5	3
Nominal current (A)	7.5	13	25
Contact resistance (Ohm)	≤ 0.005	≤ 0.002	≤ 0.002
Contact retention in the insert (N)	≥ 30	≥ 40	≥ 45

- Contact arrangements electrical characteristics

Test voltage at sea level (Vrms)	1500	2300	2800
Contact arrangements	14V-17P-22B 23C-212AF-38J 315K	27E-337P 439R	319L-419AR

DESCRIPTION

SLX series are derived from the standard SL series, and have the particularity to use machined contacts with crimp barrels. The one part Neoprene insert provides a use in a temperature range from -55°C to 125°C, the possibility to change the contacts for reparation, and an higher test voltage capability. 12 different contacts arrangements are available which include different contact gauges (20, 16, 12) in the four different shell sizes 10, 20, 30 & 40. SLX series panel drilling is the same as for SL series and SLX series connectors are intermatable with SL series connectors (SLX Plug with SL Receptacle and vice versa).

*Crimp removable
contacts
125°C*

APPLICATIONS

- Instrumentation
- Robotics
- Power supplies
- Transportation
- Entertainment (brand-lights)

SLX



Amphenol

• Contacts and wires

Contact gauge AWG	Crimp barrel		Pin diameter (mm)	AWG gauge	Section mm ²		Diameter over conductor (mm)		Maxi diameter over sleeving (mm)
	Internal diameter in mm	Depth in mm			mini	maxi	mini	maxi	
12	2.5	7.5	3	14-12	1.80	3.30	1.7	2.45	4.2
16	1.95	6.4	1.6	20 -> 14	0.60*	1.91	1	1.9	2.8
20	1.35	4	1	24 -> 18	0.22**	0.93	0.6	1.3	2.4

* The use of a 800629 reducing sleeve is necessary for cable section less than 0.60 mm² for # 16 contacts

** The use of a 800612 reducing sleeve is necessary for cable section less than 0.22 mm² for # 20 contacts

• Dimensions of the connectors

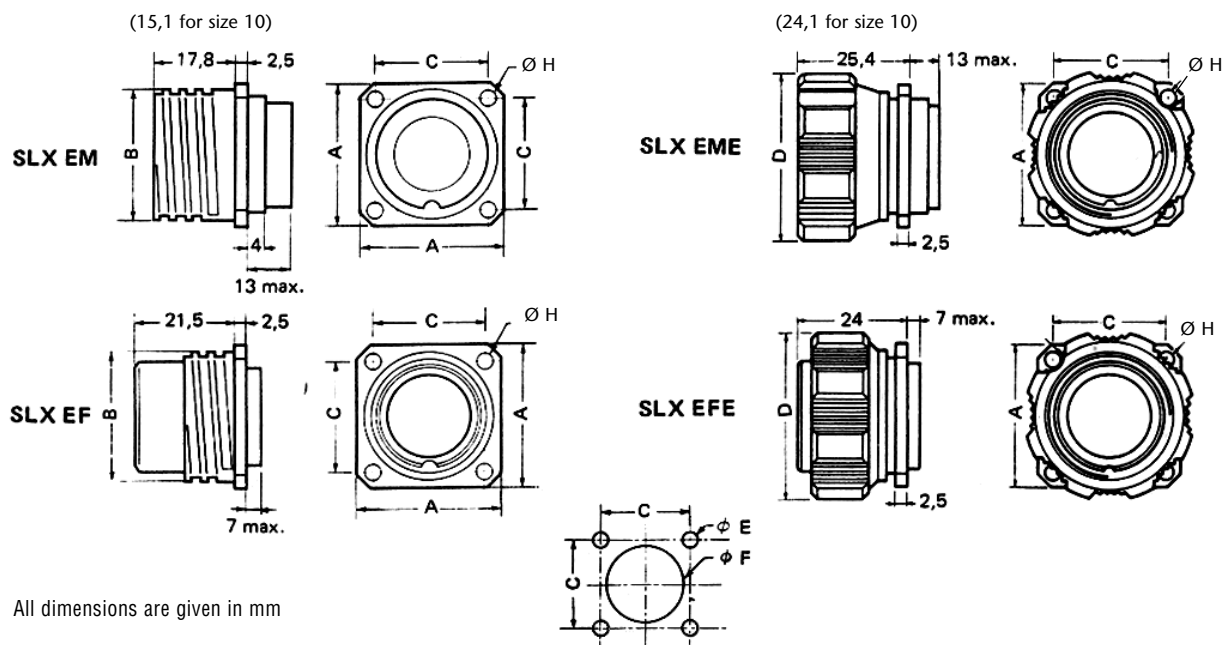

All dimensions are given in mm

For more details about dimensional characteristics, please refer to standard SL data-sheet.
Some dimensions mentioned below regarding insulators are specific to SLX series.

Receptacle size	A (mm)	Diam. B (mm)	C (mm)	Diam. D (mm)	Diam. E (mm)	Diam. F (mm)	Diam. H (mm)
10	25	21	19	28	3.2	16.5	3.2
20	31	28.1	24	37	3.5	25.5	3.5
30	46	42.2	34	52	3.5	35.5	3.5
40	56	52.2	41	65	3.5	47	3.5

Contacts insert arrangements

Mating face view of the male insert

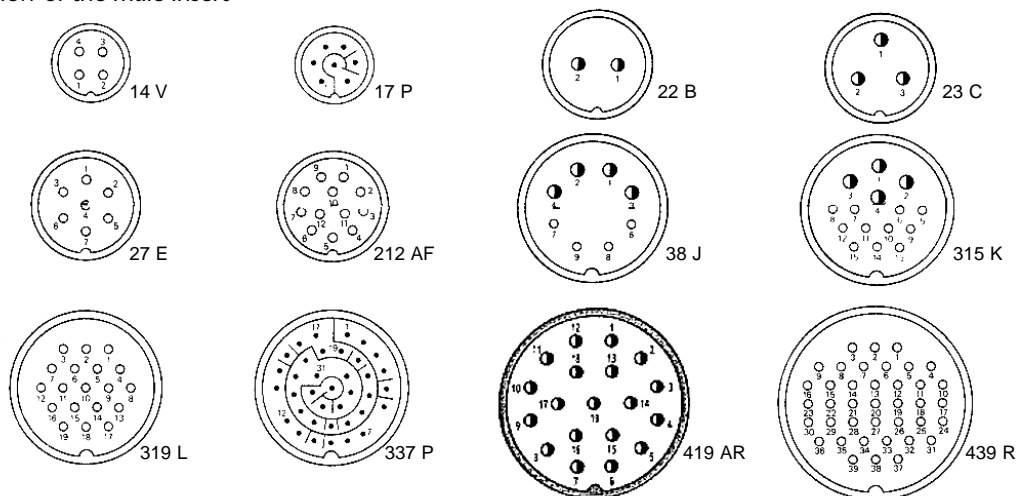

Straight or right-angle backshell

Connector size	Backshell reference					
	black (non conductive)	straight nickel (conductive)	green cadmium (conductive)	black (non conductive)	right-angle nickel (conductive)	green cadmium (conductive)
10	47377N	47377NI	21458N	47381N	47381NI	21462N
20	47378N	47378NI	21459N	47382N	47382NI	21463N
30	47379N	47379NI	21460N	47383N	47383NI	21464N
40	47380N	47380NI	21461N	47384N	47384NI	21465N

- Straight or right-angle backshells are delivered with different clamping pads.
- Green backshells (conductive finish) are delivered with metallised clamping pads.

Contacts as spare parts

Contact gauge AWG	12	16	20
Part-number for one pin	21713	800660	800650
Part-number for one socket	21728	800664	800654

Accessories

Plug and receptacle protection caps:

SLB	F	M	3B
F: Plug			
E: Receptacle			
M: Pin connector			
F: Socket connector			
Plug and receptacle: none			
Line mount receptacle: R			
Size			
1B: 10	3B: 30		
2B: 20	4B: 40		



Receptacle with locking ring protection caps:

BF	F	3B
M: Pin connector		
F: Socket connector		
Size		
1B: 10	3B: 30	
2B: 20	4B: 40	



Sealing sleeve:

Connector	Size	Ref.
Straight	10	43458
Right-angle	10	43473
Straight	20	43456
or	30	44666
Right-angle	40	43457



for plug or line mount receptacle

Adaptator for flexible conduit and PG:

	Connector size	PG thread
SL RF 209N	20	9
SL RF 211N	20	11
SL RF 313N	30	13
SL RF 316N	30	16
SL RF 416N	40	16
SL RF 421N	40	21
SL RF 429N	40	29



Cabling tools

- Crimping tools
 - Crimping pliers: **809857** (Mil. P/N: M22520/1-01)
 - Positioner: **21770**
- Controlling gauge: **809907** (Mil. P/N: M22520/3-1) (Selector number: 4)
- Contacts insertion and removal

Contacts	Insertion tool P/N	Removal tool P/N
# 12: Pin	141900	21746
# 12: Socket	141900	21745
# 16: Pin	48680	809731
# 16: Socket	48680	809732
# 20: Pin	39048	809729
# 20: Socket	39048	809730

Cabling process

- Crimping process

Place the positioner in the pliers.
Choose the selector number on the positioner according to the contact size to crimp.
Strip the wire end (7.5mm for size 12 contact / 6mm for size 16 contact / 4mm for size 20 contact).
Insert the wire in the crimp barrel of the contact and check through the inspection hole of the contact that wire is well-placed.
Place the contact with the wire into the pliers until the stop. Completely close the tool and after, let it open itself.
Visually check if crimping is correct and by the inspection hole of the contact if the wire is well-placed in the crimp barrel.

- Contact insertion

Insert the wired contact in the groove of the tool, taking care that the extremity of the tool touches the shoulder of the contact. Insert the contact in its cavity from wiring side and steadily push the tool along the axis of the cavity until the contact locks home.
Carefully withdraw the tool, applying a forward pressure on the wire.
Pull on the wire to check that the contact is correctly locked.
- Contact removal

Insert the tool from the mating side and push it along the contact axis until contact unlocks.
Pull the contact out from the rear of the connector.

Connectors

In-line receptacle or plug body

SLX series	SLX	B	M	-	27E	-
Mobile plug or in-line receptacle						
Contacts: M: pin F: socket						
Shell style: None: plug R: in-line receptacle						
Insert arrangement (See previous page 2)						
Add "NI" for cadmium-free versions (nickel)						

Plug and backshell set

SLX series	SLX	F	M	D	27E	-
F: Plug or line mount receptacle						
type of contact: M: Male F: Female						
D: Plug + straight backshell DR: Line mount receptacle + backshell C: Plug + right angle backshell						
Contact arrangement (See page 2)						
Add "NI" for cadmium free versions (nickel)						

Square flange receptacle or square flange receptacle with mating screw*

SLX series	SLX	E	F	-	27E	-	-
Receptacle							
Contacts: M: pin F: socket							
Shell style: None: square flange receptacle E: square flange receptacle with mating screw							
Insert arrangement (See previous page 2)							
Add "MA" for tin plated retention ring (grounding)							
Add "NI" for cadmium-free versions (nickel)							

* (Receptacle with mating screw mates with in-line receptacle)
Connectors are delivered with non-fitted contacts to allow the crimping process.
Comment: Panel gasket is delivered with the receptacle.

Do not hesitate to contact us for further information