

BROADWAY COMPONENT IDENTIFICATION DIAGRAM

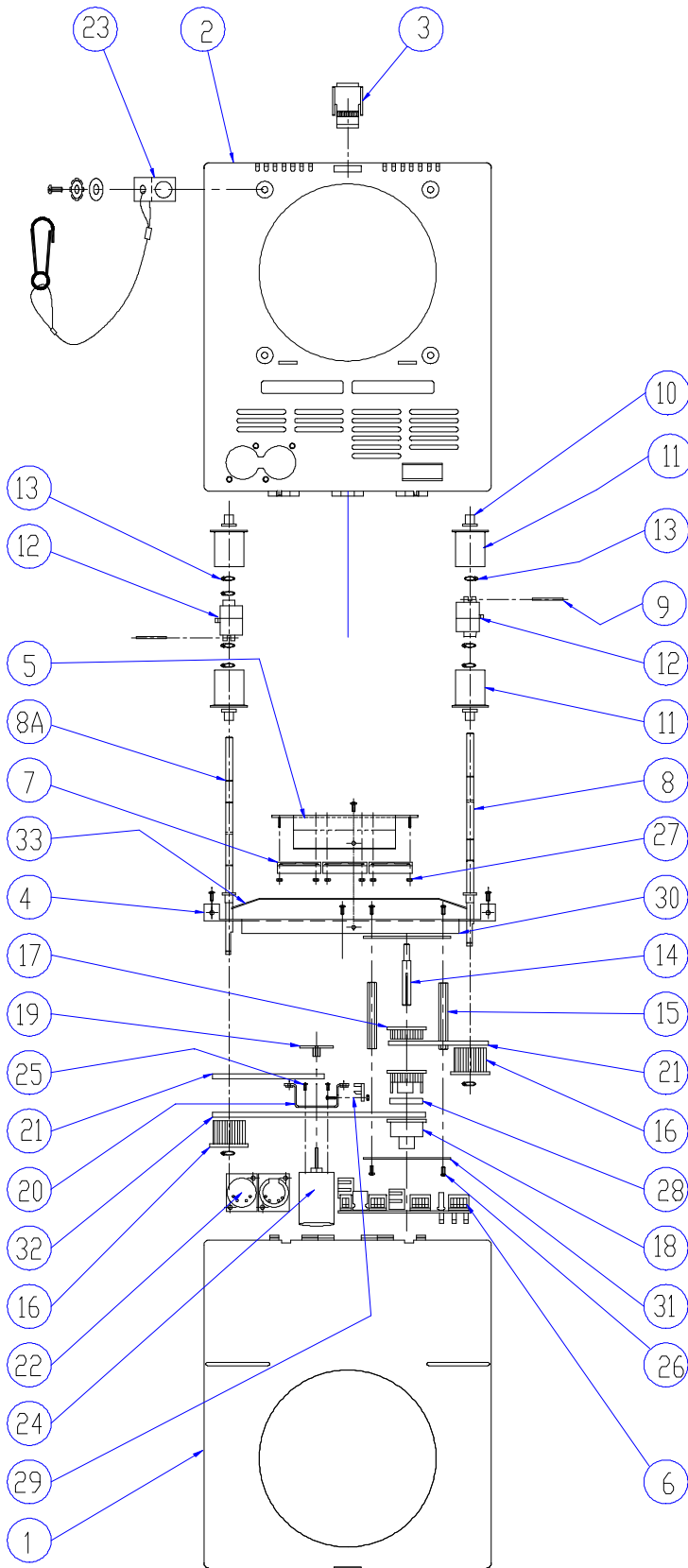

FRONT VIEW

- CQB- 1. Front Case
- CQB- 2. Rear Panel (Back View) Basic Case
- CQB- 3. Latch
- CQB- 4. Drive Plate
- CQB- 5. Fan Plate
- CQB- 6. Digital Broadway Controller
- CQB- 7. Fan Ass'y (3)
- CQB- 8. Broadway Driven Shaft (Right)
- CQB- 8a. Broadway Drive Shaft (left)
- CQB- 9. Spring pins 3/32 x 1/2 (2)
- CQB- 10. 6mm Bushings (6)
- CQB- 11. Leader Wheel (4)
- CQB- 12. Centre Wheel (2)
- CQB- 13. Circlip(s) 8mm for shafts(8)
- CQB- 14. Tensioner Shaft
- CQB- 15. M3 x 55 Stand off(2)
- CQB- 16. Tensioning Pulley (2)
- CQB- 17. Tension Gear (2)
- CQB- 18. Tension Spring Housing Cover
- CQB- 19. Opto Wheel
- CQB- 20. Motor Mount Bracket
- CQB- 21. Small Belt T2.5/177.5 (2)
- CQB- 22. XLR assembly M/F/plate/leads
- CQB- 23. Safety chain Assembly Kit
- CQB- 24. Mabuchi Motor with leads and Chokes
- CQB- 25. M3 x 6 Cheese Head Phillips Screw Zinc(2)
- CQB- 26. M3 x 6 Cheese Head Phillips Screws Blk (8)
- CQB- 27. M3 Hex Comby Nuts (6)
- CQB- 28. Clock Spring
- CQB- 29. Opto Encoder Assembly (2)
- CQB- 30. Tensioner Top Plate
- CQB- 31. Tensioner Bottom Plate
- CQB- 32. Large Belt T2.5/330
- CQB- 33. Static Wire